

Unit Floor Plan

3 BEDROOM PLUS - TYPE 1

SUITE AREA	1,442 - 1,443 SQ.FT
BALCONY AREA	337 - 420 SQ.FT
TOTAL AREA	1,779 - 1,863 SQ.FT

1. KITCHEN	2.8m X 2.2m
2. LIVING & DINING	4.3m X 5.2m
3. POWDER ROOM	2.0m X 1.3m
4. MASTER BEDROOM	3.47m X 4.0m
5. WALK IN CLOSET	1.6m X 2.8m
6. MASTER BATHROOM	2.0m X 3.6m
7. BEDROOM 1	3.8m X 3.8m
8. BATHROOM	3.0m X 1.6m
9. BEDROOM 2	3.8m X 3.8m
10. BATHROOM	2.6m X 1.6
11. LAUNDRY 1	0.9m X 0.9m
12. BATHROOM	2.0m X 1.2m
13. STORAGE	2.2m X 1.9m

Balconies and entrance varies depending on the Floor

All images used are for illustrative purposes only and do not represent the actual size, features, specifications, fittings and furnishings. The developer reserves the right to make revisions / alterations, at its absolute discretion, without any liability whatsoever.

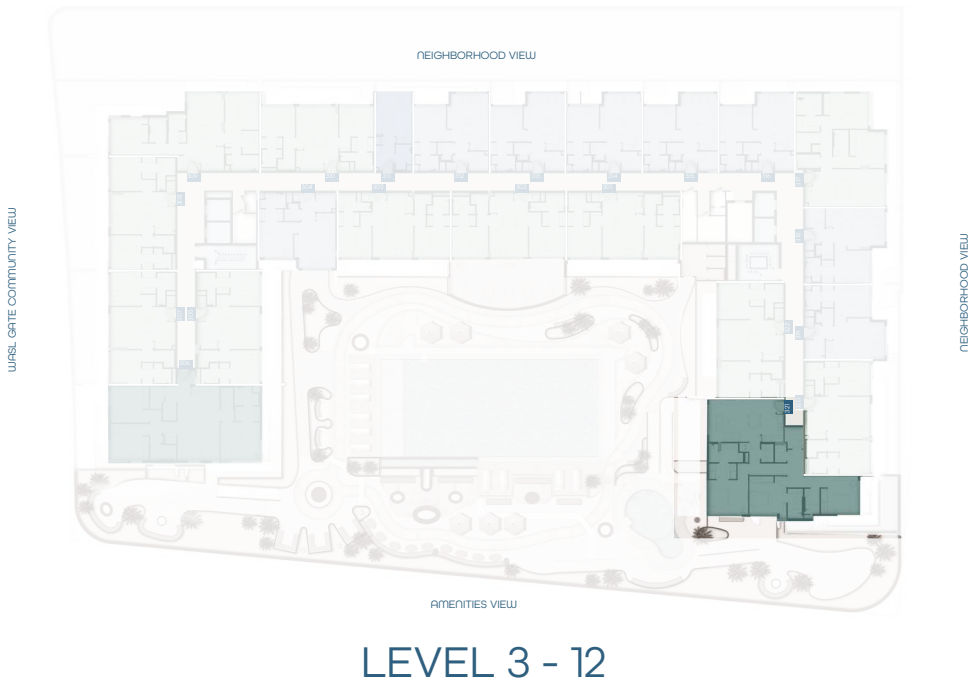
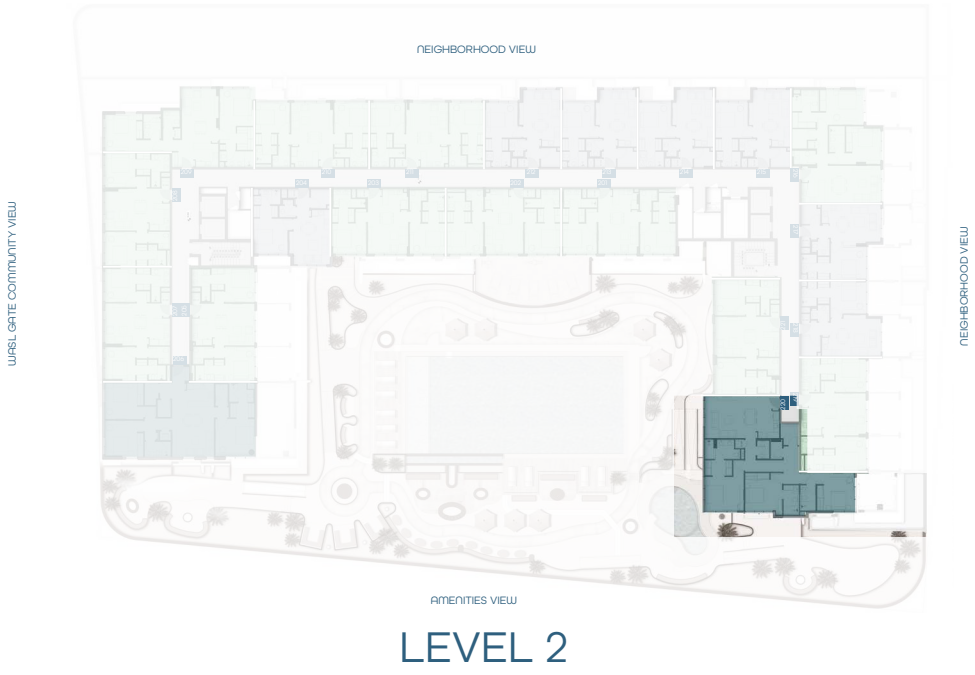
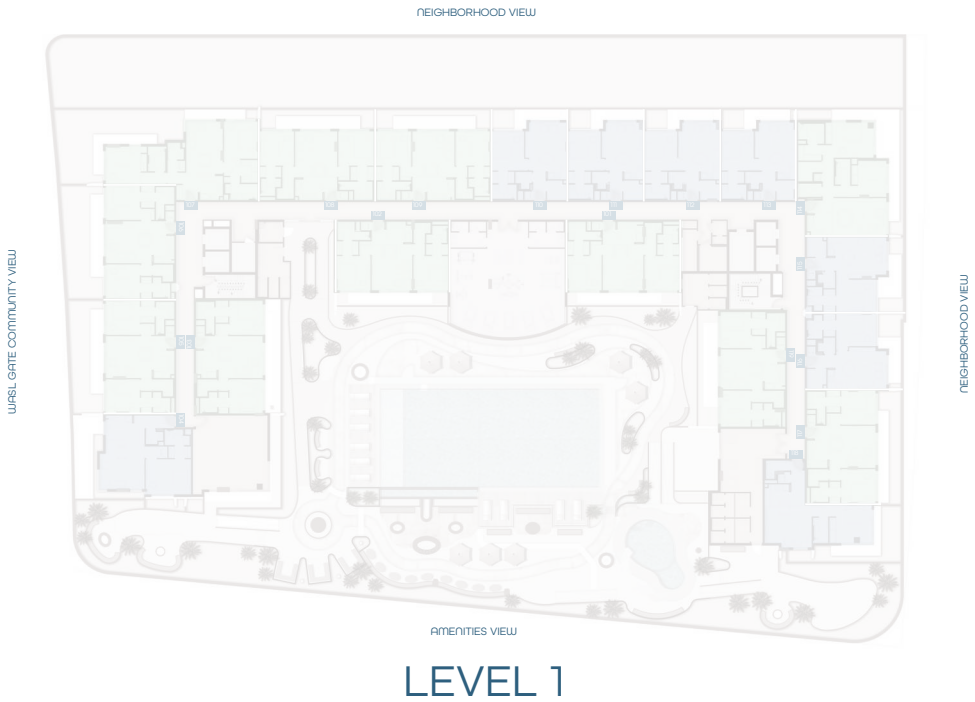

Unit Floor Plan

3 BEDROOM PLUS - TYPE 2

SUITE AREA	1,355 SQ.FT
BALCONY AREA	276 - 342 SQ.FT
TOTAL AREA	1,631 - 1,697 SQ.FT

1. ENTRANCE	1.6m X 1.3m
2. KITCHEN	2.45m X 2.8m
3. LIVING & DINING	5.1m X 4.3m
4. POWDER ROOM	2.35m X 1.3m
5. MASTER BEDROOM	3.9m X 4.4m
6. WALK IN CLOSET	1.5m X 2.9m
7. MASTER BATHROOM	1.95m X 3.0m
8. BEDROOM 1	3.75m X 3.9m
9. BEDROOM 2	3.7m X 3.9m
10. BATHROOM	1.6m X 3.1m
11. LAUNDRY 1	0.95m X 1.0m
12. BATHROOM	1.8m X 1.8m
13. STORAGE	2.3m X 1.45m

Balconies and entrance varies depending on the Floor

All images used are for illustrative purposes only and do not represent the actual size, features, specifications, fittings and furnishings. The developer reserves the right to make revisions / alterations, at its absolute discretion, without any liability whatsoever.

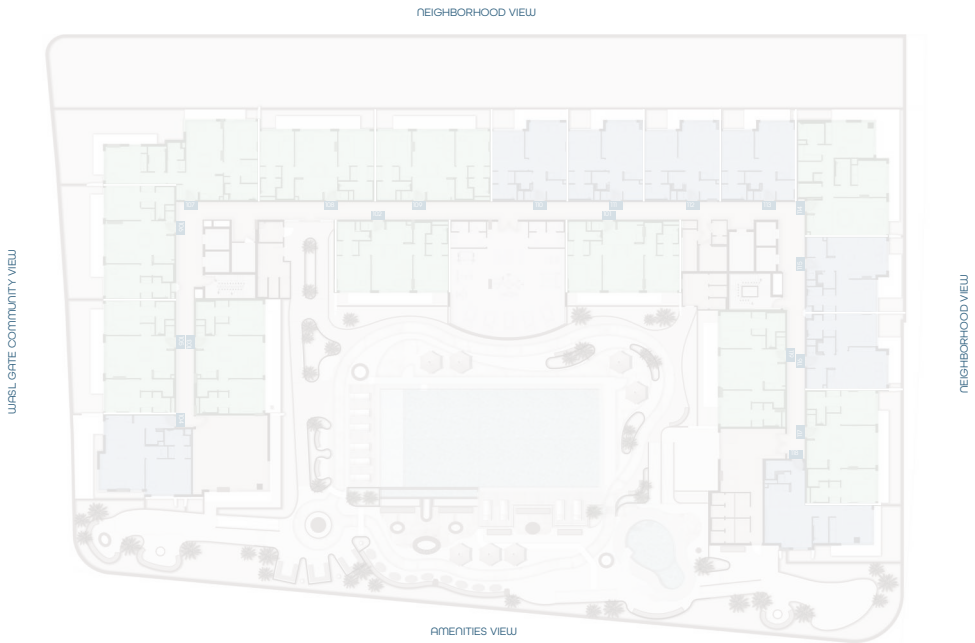

LEVEL 1

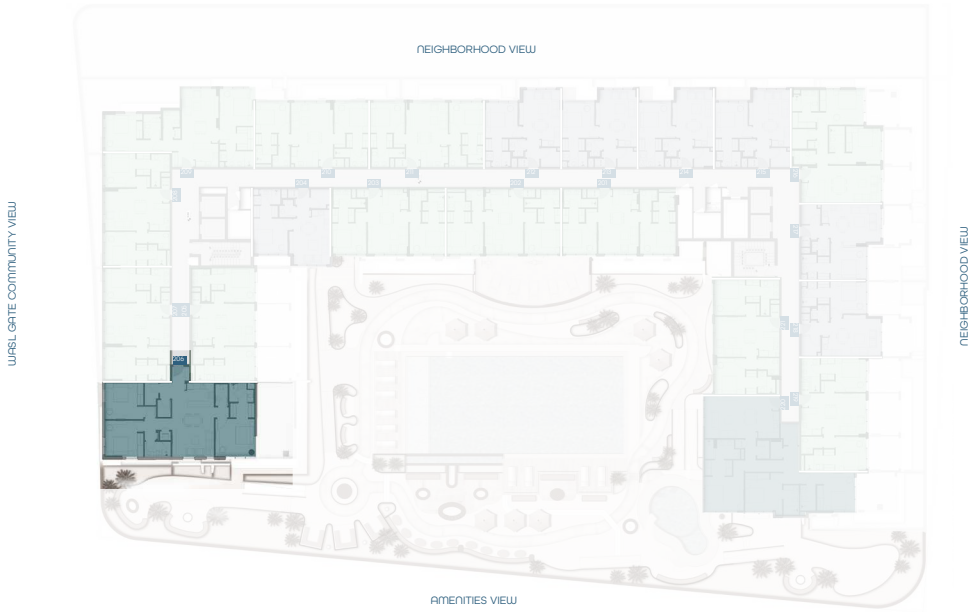

LEVEL 2

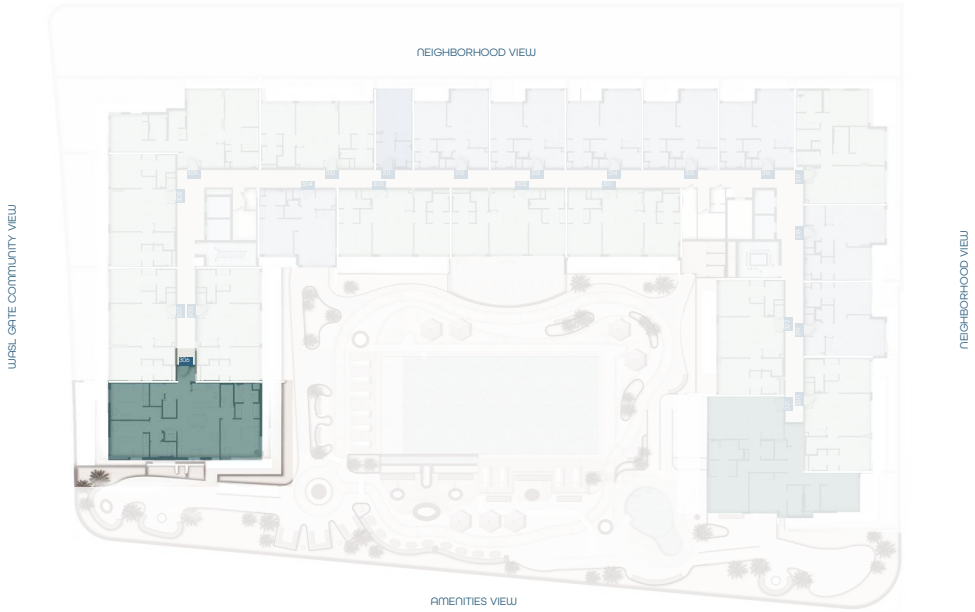

LEVEL 3 - 12

